

p a s a c a b l e s

1.1. PASACABLES NORMALES

REF.	A	B	C	D	E	F
206	8	3	5	5	1	2
102	15	4'5	9	10	1	4'5
2051	12	5'5	9'5	8	1	3'5
2052	12	5'5	9'5	9	2	4
201	15	7	10	8	1'5	3'2
2071	20	7	15	9	1	4
4016	20	7	15	10	2	4
221	17	8	11	8	1'5	3'2
222	18	8	12	9	2'5	3'2
200	22	9	13	8	1'5	3'2
2101	22	10	13	9	1'5	3'2
2121	24	12	16	7	1	3
2122	24	12	16	8	2	3
4020	24	12	16	10	4	3
211	27	14	17	9	1	4
2142	27	14	17	10	2	4
210	30	18	20	6	1	3
207	35	19	27	7'5	1'5	3
208	38	22	30	9	2	3'5
209	40	25	30	8'5	1'5	3'5

Esq. 01

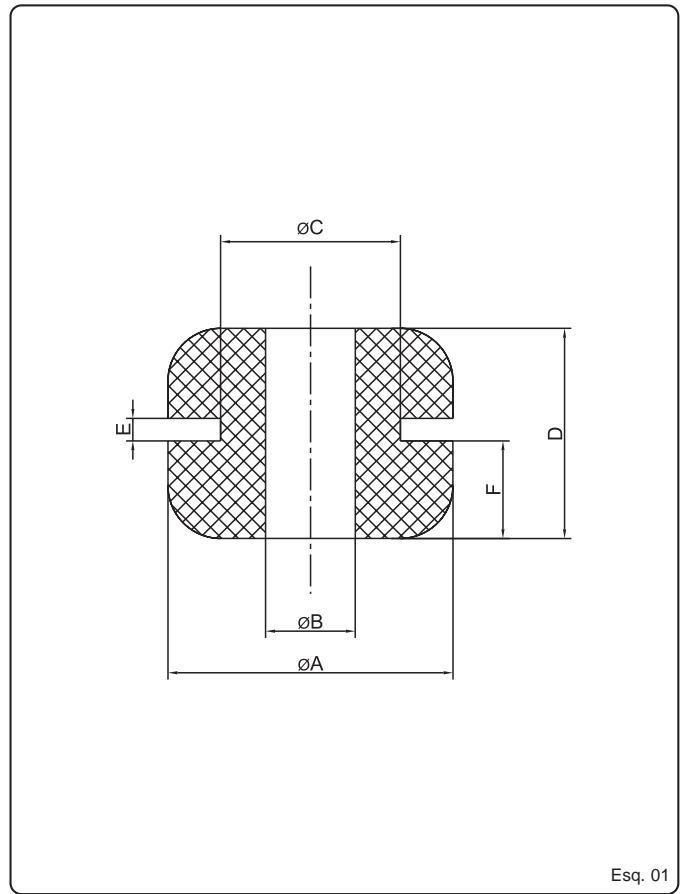

Esq. 01

1.2. PASACABLES CÓNICOS

REF.	A	B	C	D	E	F	G
2061	25	3	1	15	11	6	9
2062	26	3	2	15	11	6	9
2081	22	3	1	12	8	4	7
2082	23	3	2	12	8	4	7
245	12	4	8	10	2	2	5
255	12	4	8	12	2	3	5

Esq. 02

REF.	A	B	C	D	E	F	G	H
246	44	3	3	16	12	7	5	9
246B	42	3	1	16	12	7	5	9

Esq. 03

REF.	A	B	C	D	E	F	G	H
227	60	3	2	16	12	8	8	11
227B	59	3	1	16	12	8	8	11

Esq. 04

REF.	A	B	C	D	E
704	50	3	5	14	8

Esq. 05

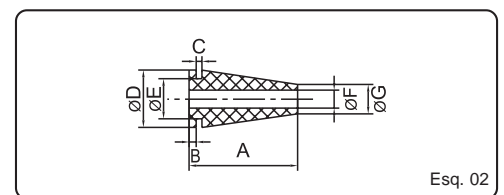

Esq. 02

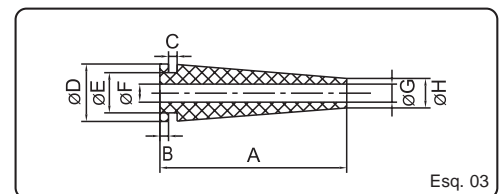

Esq. 03

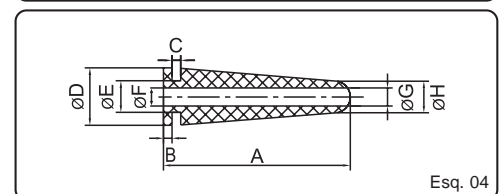

Esq. 04

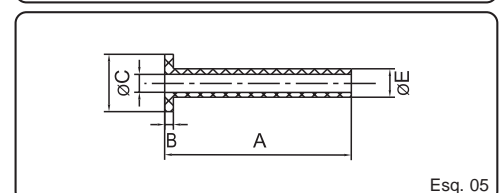

Esq. 05

1.3. PASACABLES CILÍNDRICOS

REF.	A	B	C	D	E
314	13	5	8	5	1
1006	17	7	12	10	2
399	17	9	12	14	1'5

Esq. 06

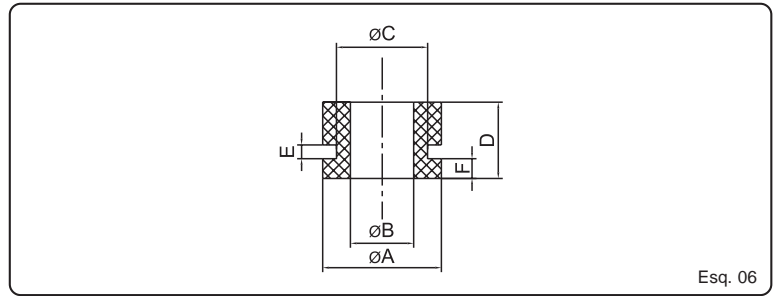

Esq. 06

t o p e s

2.1. TOPES A PRESIÓN CON RANURA

REF.	A	B	C	D	E	F
667	9	4	5	6	2	12
663	13	5	8	3	1	9
664	13	5	8	3	2	10
10151	14	7	10	5	1	14
10152	14	7	10	5	1'5	14'5
10155	14	7	10	5	5	16
10081	22	9	11'5	15	1	25
10083	22	9	11'5	15	3	27

Esq. 07

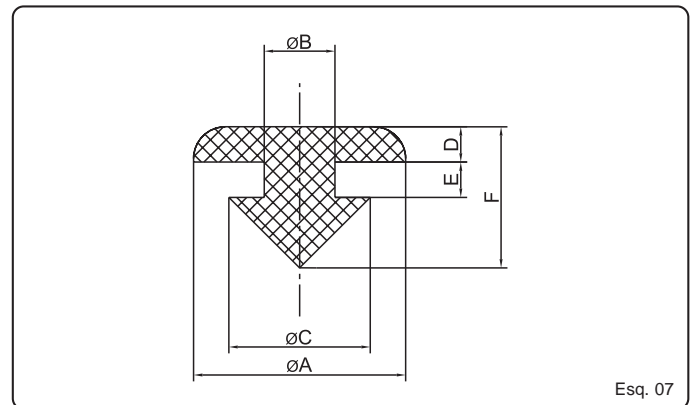

Esq. 07

REF.	A	B	C	D	E	F
643	5	4	5	2'5	1	5
621	10	6	8	3	1	6
622	10	6	8	3	2	7
1223 a	19'5	10'5	14	10	1	19
1223 b	19'5	10'5	14	10	2	20

Esq. 08

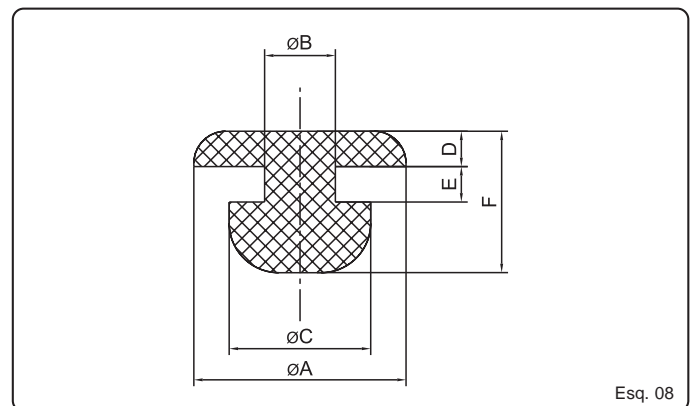

Esq. 08

2.2. TOPES A PRESIÓN CON RABILLO PARA MONTAJE

REF.	A	B	C	D	E	F
670	6	3	5	6	2	15'5

Esq. 09

REF.	A	B	C	D	E	F
662	11'5	5	5	1	7	22
671	12	7	7	1	13	23

Esq. 10

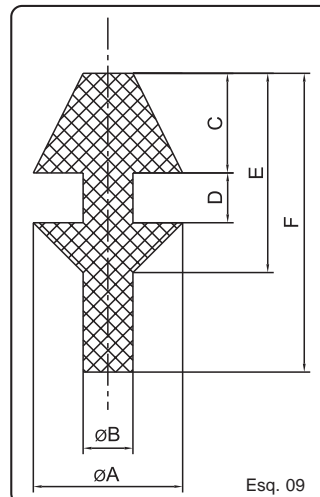

Esq. 09

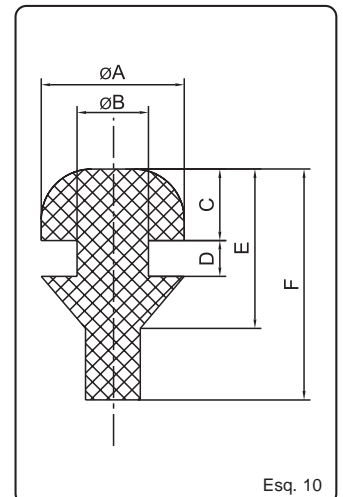

Esq. 10

2.3. TOPES A PRESIÓN CILÍNDRICOS

REF.	A	B	C	D
640	8	5	3	8
642	6	3	2	8
642B	6	4	2	8

Esq. 11

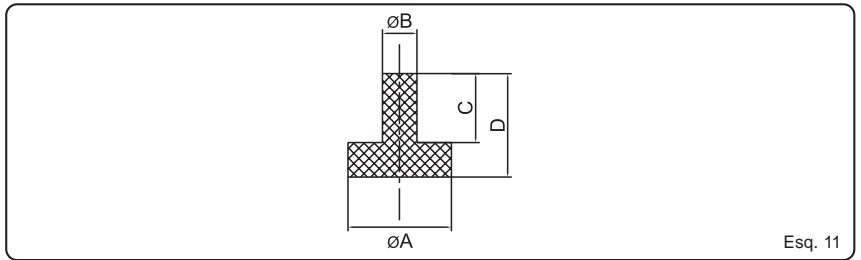

Esq. 11

2.4. TOPES A PRESIÓN DEL TIPO SETA

REF.	A	B	C	D
601	20	12	14	24
602	13	9	7	15
603	12	5	6	16

Esq. 12

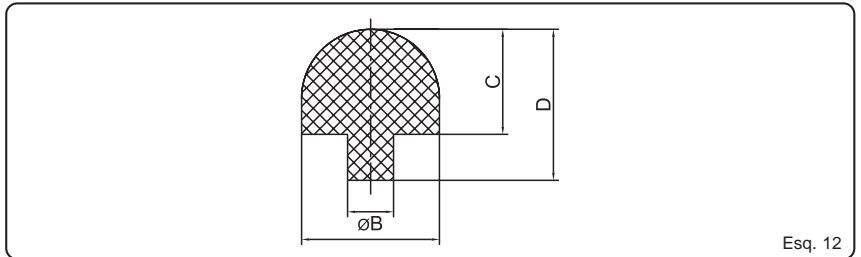

Esq. 12

2.5. TOPES O PATAS FIJACIÓN POR TORNILLO

REF.	A	B	C	D	E
802	18	3	8	8	4
801	23	3'5	10	10	5

Esq. 13

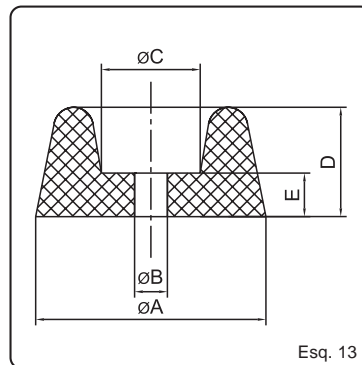

Esq. 13

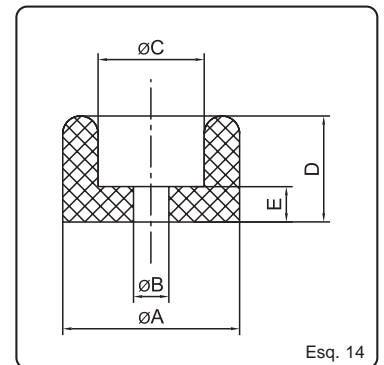

Esq. 14

REF.	A	B	C	D	E
806	20	3	7	13	4
840	14	3	7	9	4

Esq. 14

REF.	A	B	C	D	E
814	25	5	17	7	4

Esq. 15

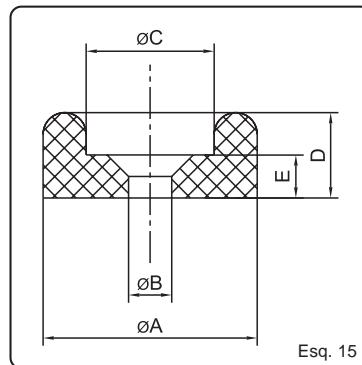

Esq. 15

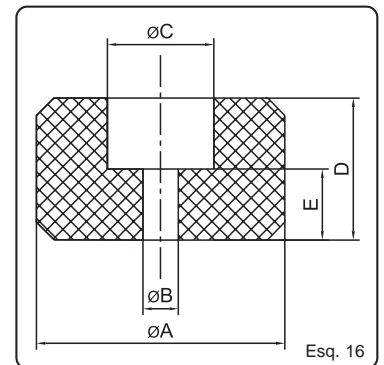

Esq. 16

REF.	A	B	C	D	E
820	32	5	13	18	9
822	32	5	12	36	10

Esq. 16

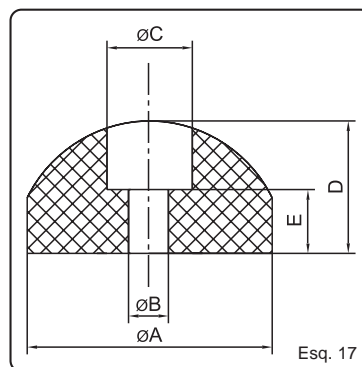

Esq. 17

REF.	A	B	C	D	E
821	33	5	12	19	9
824	15	3	5'5	9	4

Esq. 17

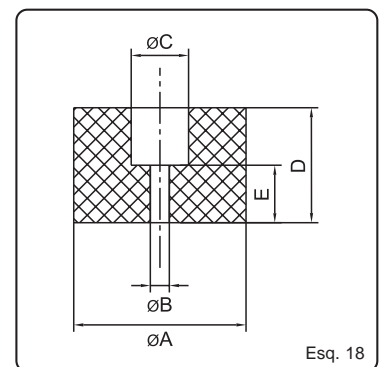

Esq. 18

REF.	A	B	C	D	E
825	32	6	13	25'5	17
826	38	8	20	24	15
1211	24	4	10	12	7
1212	24	4	10	18	9

Esq. 18

2.6. TOPES O PATAS ADHESIVAS

REF.	A	B
901	13	3
902	14	5

Esq. 19

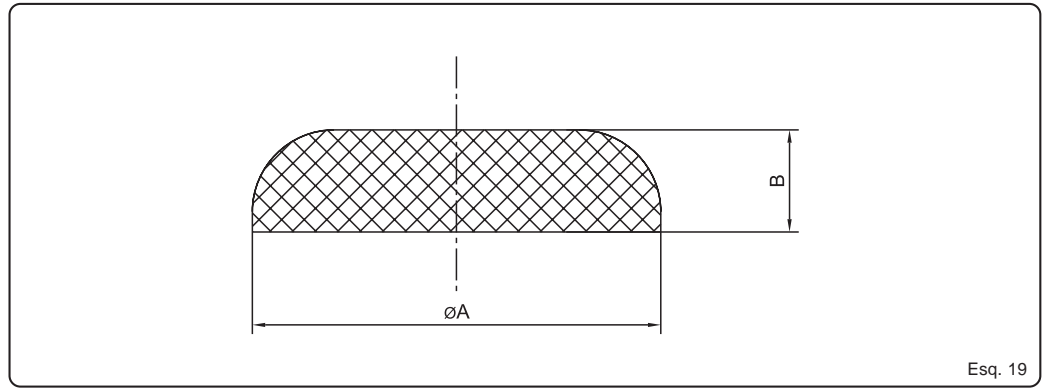

Esq. 19

2.7. REMATE O PATA PARA TUBO

REF.	A	B	C	D	E
10117	27	17	32	22	27
10119	27	19	32	22	27
10122	27	22	32	22	27

Esq. 20

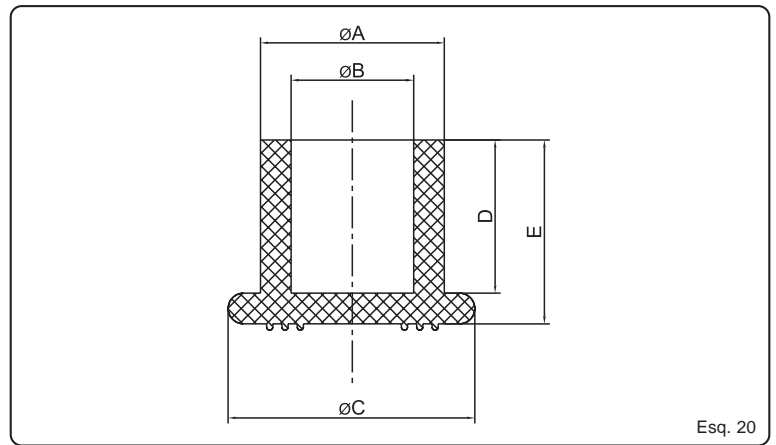

Esq. 20

2.8. PIE CÓNICO

REF.	A	B	C	D	E	F	G	H
1021	51	38	34	55	10	40	48	58

Esq. 21

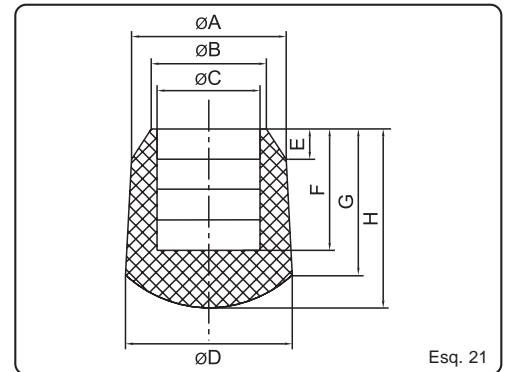

Esq. 21

a r a n d e l a s

3.1. ARANDELAS PLANAS

REF.		A	B	C
9091	3/8"	9'8	14'6	2
9101	1/2"	10'5	18	2
9121	1/2"	12	18	2
9122	3/4"	12	24	2
9181	3/4"	18	23	2
9231	1"	23	29	2
9291	1/4"	29	37	2

Esq. 22

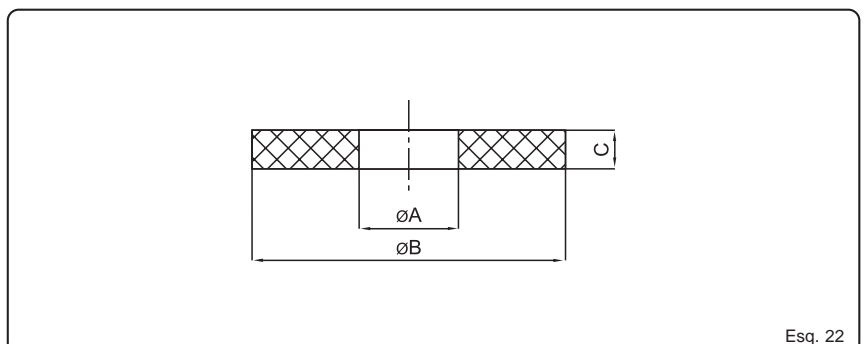

Esq. 22